



● Feature

RM085G-H4 is 8mm ceramic adjustable resistor, rated power 0.5w, lead pitch 5*5, with tolerance of 20% and 10% (need to be customized), it has cap and the adjust point is on the side.

● Applications

Widely used in the security products such as the building talk-back and household electric products.

● Dimensions

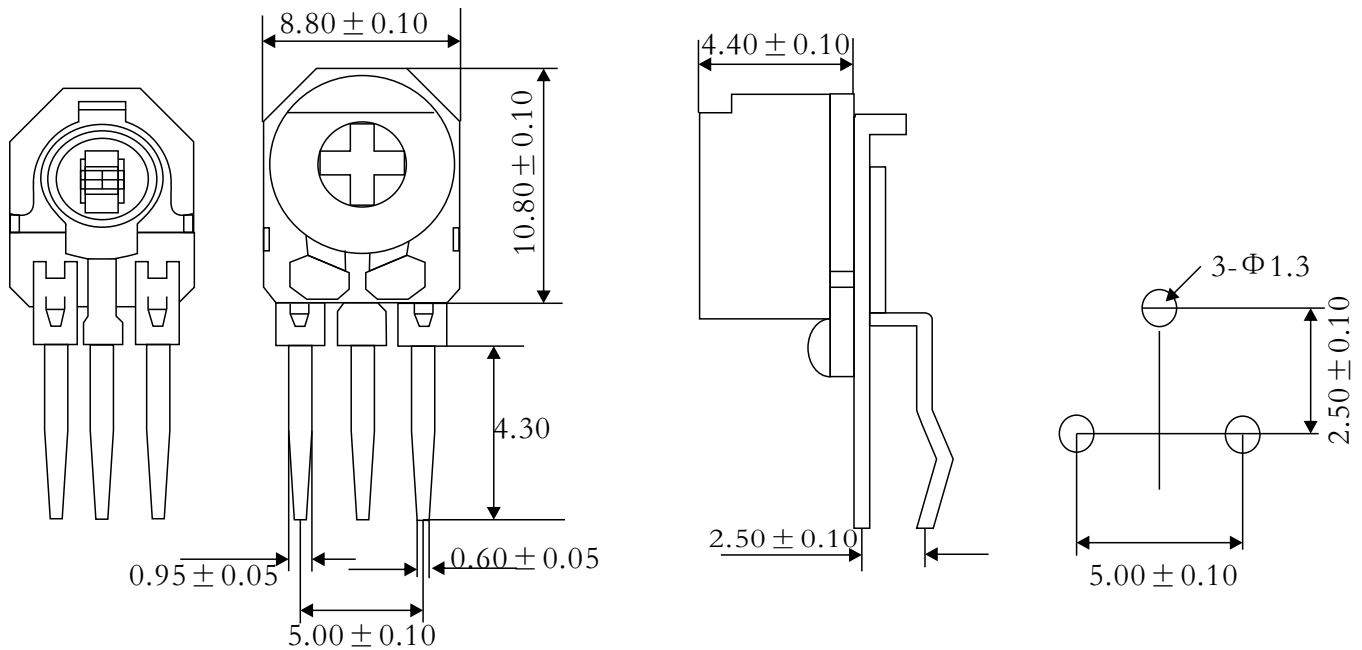

● Applications And Ratings

Type	Rated Power(W)	MaxWorking Voltage(V)	Resistance Range(Ω)	TCR (PPM/ $^{\circ}$ C)	Tolerance Range	Operating Temperature
RM085G-H4	0.5	AC30V	100~4.7M	± 250 PPm/ $^{\circ}$ C	$\pm 20\%$	-40 $^{\circ}$ C -125 $^{\circ}$ C

● Reference Standards

JIS C 5201-1

Ordering Information

Example

RM085G-H4	0.5	M	10R00	A
(1)	(2)	(3)	(4)	(5)
Series Name	Power Rating	Resistance Tolerance	Resistance	packing

(1)Type: RM085G-H4 SERIES

(2)Power Rating: 0.5=0.5W

(3)Tolerance: M \pm 20%

(4)Resistance Value: 0R100=0.1 Ω ,0R220=0.22 Ω ,10R00=10K Ω ,1M000=1M Ω

(5)packing:Blk Bulk

Performance

Resistance Range(Ω)	100~4.7K
Tolerance	\pm 20%
Characteristics of the resistance change	B
MaxWorking Voltage(V)	AC30V
Rated Power	0.5W
Rotational noise	100mV
Residual resistance	$R \leq 1k\Omega$, r01,r03 $\leq 10\Omega$ $R > 1k\Omega$, r01,r03 $< 1\%R$
Rotational angel	240° \pm 10°
Starting torque	5~35mN.m
Shaft stopper strength	50mN.m